



120&180kW Integrated DC Charger instructions



Contents

CONTENTS	2
ATTENTION	3
STATEMENT	6
BEFORE USE	1
1.1 OPENING CONFIRMATION	1
1.2 EV CHARGER	2
INSTALLATION PREPARATION	7
2.1 EXTERNAL PREPARATION	7
2.2 INSTALLATION BASIS	7
INSTALLATION METHOD	8
3.1 INSTALLATION PRECAUTIONS	8
3.2 CHARGING EQUIPMENT INSTALLATION	9
3.3 WIRING AND EARTHING	12
3.4 DEBUG DETECTION	12
INSTRUCTIONS	13
4.1	13
2.3 CHARGING STEPS	13
4.2 PRECAUTIONS FOR USE	14
4.3 SETTING DIAL CODE	15
TROUBLESHOOTING	16
3.1 POSITION OF DEVICE ABNORMAL DISPLAY	16
3.2 COMMON TROUBLESHOOTING METHODS	16
AFTER-SALES SERVICE (REPAIR)	19
4.1 INSPECTION METHOD	19
4.2 REPAIR/REPLACEMENT OF PARTS	22
4.3 UPGRADE METHOD	22
4.4 REPAIR AND TRAINING	22

Attention

To prevent accidents from causing damage to your personal and property, the following statement should be made on matters needing attention.

■ Distinguish and explain the degree of injury and damage caused by misuse of this product.



The sign indicates the relevant content of "most likely to lead to death or serious injury".



The sign indicates the relevant content of "most likely to cause injury or property damage".

■ The following graphic markers are used to illustrate the matters to be complied with.



The sign means "content strictly prohibited".







The sign means "content must implement"



	<p>It is strictly forbidden to approach dangerous articles such as flammable, explosive or combustible materials, chemicals, combustible steam to the charger.</p>	<p>It may cause a fire</p>
	<p>It is strictly forbidden to disassemble, repair or refit the charger beyond the scope of the instructions.</p>	<p>Improper operation may cause charger damage, leakage, leakage of electricity, and serious casualties</p>
	<p>It is strictly forbidden to use</p>	<p>Accidental injury caused</p>

Instructions for CL5830Charger

	<p>charger when cracks, wear, rupture or bare charging cables occurred on charging plugs or cables. (If the above dangerous situation is found, please contact the after-sales personnel in time)</p>	<p>by electric shock</p>
	<p>It is strictly forbidden to touch the charger plug core with hand when charging.</p>	
	<p>It is strictly forbidden to use the charger in bad weather.</p>	
	<p>It is strictly forbidden to open the cabinet door when charging.</p>	
	<p>Children are advised not to approach or use charger.</p>	
	<p>If fire, electric shock or other abnormal conditions occur during use, the EMERGENCY stop button should be pressed immediately.</p>	<p>If the EMERGENCY stop button is not pressed, casualties may occur.</p>
 ATTENTION		
	<p>Please charge the car after it is out of fire. During the charging process, the vehicle is forbidden to start.</p>	<p>Charger could be damaged</p>
	<p>Keep the charging plug clean and dry. If there is dirt, please wipe it with a clean dry cloth after power off.</p>	<p>Dirt will damage the protection device of charger and shorten its service life.</p>
	<p>If the LED shows machine failure (turn red), please contact the</p>	<p>Charger could be damaged</p>

Attention

	after-sales personnel first, and do not operate blindly.	
	When there is water on the surface of the charger, please do not open the chargercover shell.	

Statement

Statement:

1. This product is only used for EV charging
2. If there are any changes in the contents and specifications of this instruction, please refer to the information published on the company's website and WeChatofficial account. The final right of interpretation belongs to the company.

Before Use

1.1 Opening Confirmation

■ Abstract

The CL5830-C08 Series AC/DC Electric Vehicle Supply Equipment (herein after referred to as Charger), is mainly used for fast charging for EVs in DC and/or AC. The charger be able using in outdoor and charging multi plugs together.

■ After unpacking, please confirm

- Does EV charger match the model which you purchased?
- Is there any damage on the EV charger, include plug, cable and main body?
- Please check whether the attached accessories are same as accessorieslist.

Note: Please keep the packing box and materials for future handling.

If discrepancies are found, please contact us.

1.2 EV Charger

■ Name of parts

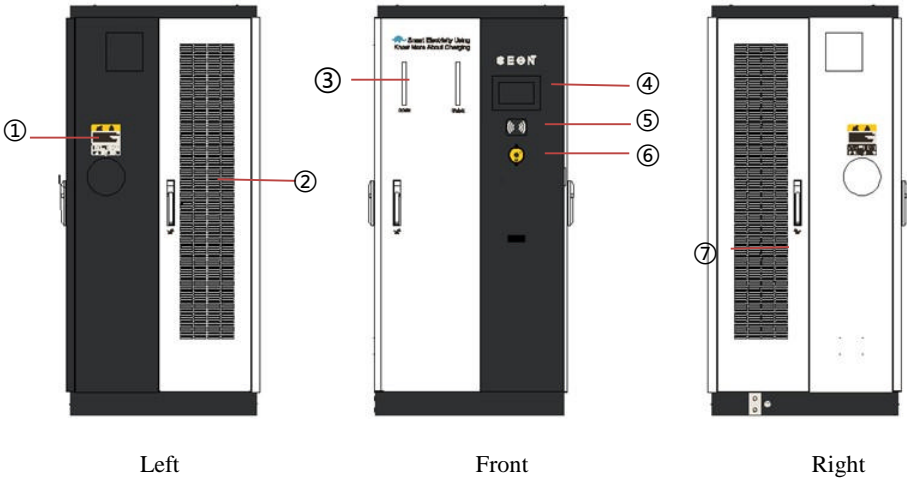

Note: The appearance of the drawing is only for illustration. Different products may have different configurations. Please refer to physical objects.

Before Use

number	Name of Parts	number	Name of Parts
1	Name Plate	6	Emergency stop
2	Air inlet	7	Air outlet
3	LED indicator	8	Case Earthing
4	Display Screen		
5	Card Reader		

■ **Specifications and technical parameters**

Model Parameters	CL5830-C08D
Charging interface	CCS2+CCS2
Input Voltage (Vac)	400V±10%
Frequency	50/60Hz
Dimensions(W*D*Hm m)	850*850*1800
Starting Mode	Card(optional)/APP(need connected with backstage)/Password
Charging Mode	AC & DC: Full charge automatically DC only: by time/ by electricity/by charge amount
Rated Power	CCS2: 120kW /180kW
Rated Current	2*CCS2: 200A
Output Voltage Range	CCS2: 150-1000V (Constant powerat 300~1000V)
Display	7-inch high definition colorful haptic LCD display
Card Reader	Reserved installation position
Communication Interface	Ethernet/4G/WIFI (Reserved installation position)
Operating Temperature	-25℃~+50℃
Storage Temperature	-40℃~+70℃
Humidity	5%~95%
Altitude	≤2000m
IP Degree	IP54
Protect Function	Protection for Leakage, Over Temperature, PE break, Over/Under-voltage, Overcurrent, short circuit and surge

■ 30kW 1000A Charge Power Module

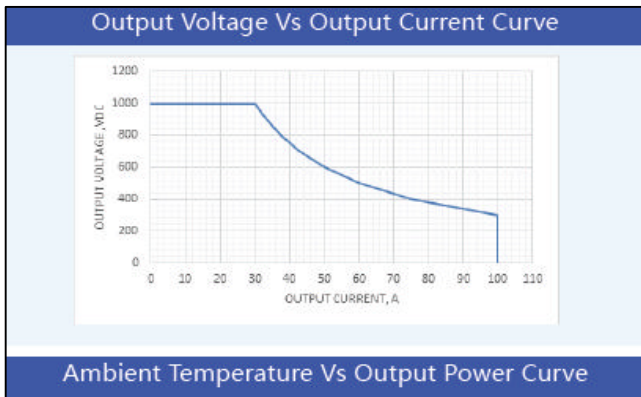
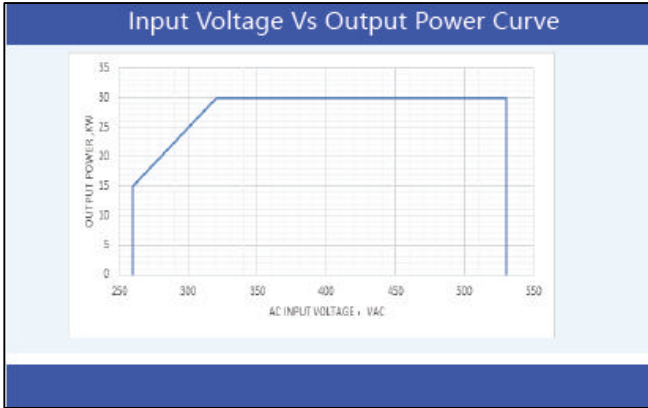

■ **Summary of Main Functions**

Peripheral Function	
LED	Green: idle Yellow: Charging Red: Fault
Display Screen	For display charging information and other functions
Emergency Stop	Stop charging emergency
Card reader	(Optional) for using Card to start charging
Charging Plug Functions	
e-Lock function (DC only)	Lock the charge plug during charging, and unlock when charging stopped.
Plug return detected function	When charge plug is idle, detected whether the plug well placed or not.
Safety protection function	
Self-Check Function	The charger detects the real time status, and upload when abnormal
Over/under Voltage protection	The charger detects the real time voltage during charging, and when over/under voltage occurred, the charger will stop charging and give an warning.
Ove Current protection	The charger detects the real time current during charging, and when over current occurred, the charger will stop charging and give a warning.
Lightning protection function	Rank CLightning protection. Protected the damage from lighting
Output Adhesion detection	The Charger detects the real time status of output contactor, stop or forbid charge, and give a warning.
Communication function	
Ethernet	Upload errors from the charger
4G	4G/3G/Wi-Fi (optional)

Installation Preparation

2.1 External preparation

Contact the owner to confirm the load and installation policy to support the installation of the charging device.

2.2 Installation basis

- The Operation Space of charger should not less than 1m when installation. The charger must be installed on the cement concrete installation base.
- Using the Drilling template, drilling holes on the installation base, put expansion bolt in the holes before installation the charger (see fig on the below)

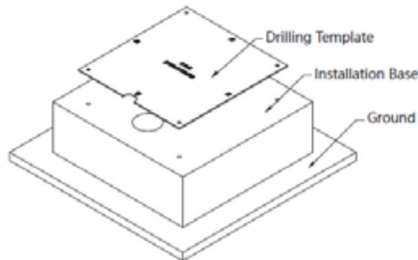

Installation method

3.1 Installation Precautions

- Please ensure that the foundation surface of the installation is flat and the strength meets the requirements before installation.
- Please open the charging equipment box door before installation, check that the accessories are complete, the wiring is good, and there is no looseness;
- If the equipment is disassembled and used at low temperature, there may be condensation of water droplets. Be sure to wait until the inside and outside of the equipment is completely dry before installing or using it. Otherwise, there is danger of electric shock;
- Please follow the wiring requirements and connect correctly;
- The wiring of the wiring is good when installing, the foaming part is closely matched with the mounting surface, and the gap should be kept between 0.5-1mm after installation;
- Make sure that the power supply is well grounded;
- Under no circumstances should you modify, add or change any parts yourself.

Note: This product must be installed by our company's maintenance department or our company's designated repairer. The company is not responsible for any problems caused by the user's private installation.

3.2Charging equipment installation

Charger installation effect diagram (the illustration is for reference only, please refer to the actual product)

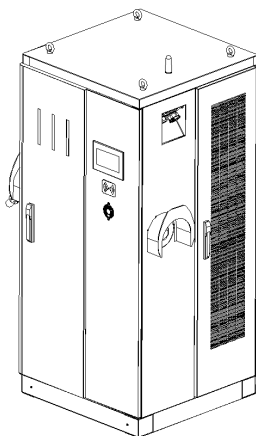

Note: The charger must be installed on a custom concrete foundation, and the foundation should be based on the installation foundation drawings or civil engineering drawings.

Installation steps:

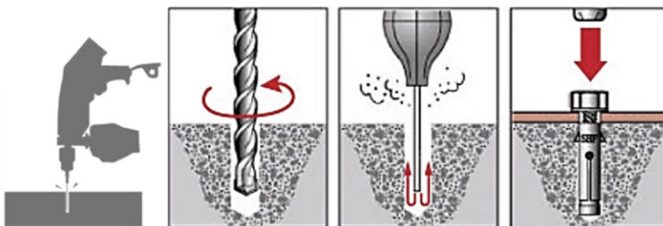

Prepare

Drill

Clear Dust

Embedded

Installation method

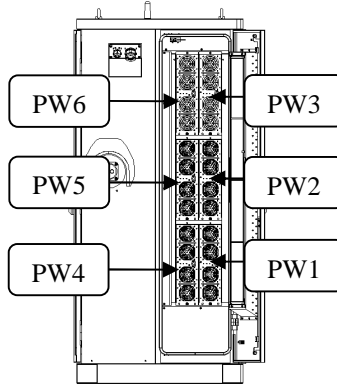
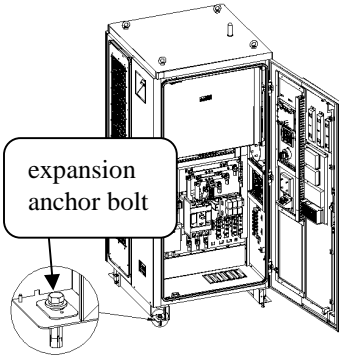

	PW1	PW2	PW3	PW4	PW5	PW6
120kW	✓	✓		✓	✓	
180kW	✓	✓	✓	✓	✓	✓

3、Place the device on the foundation and align the reserved holes with the expansion bolts in the accessory

④ Open the side door, access the cable from the bottom, and insert the module into the module slot. And put the power module in the slot

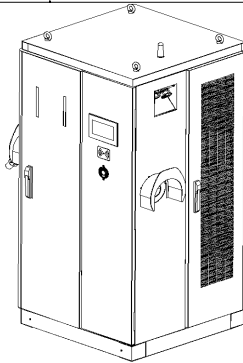

⑤ Install the front and rear sealing plates of the removed base, seal the lower part of the equipment body with protective mud, and close and lock the front door. Installation is complete.

3.3 Wiring and earthing

Connect the three-phase five-wire (380V) to the charging device, and note that the colors between the phase lines must correspond one-to-one, and the ground wire must be connected.

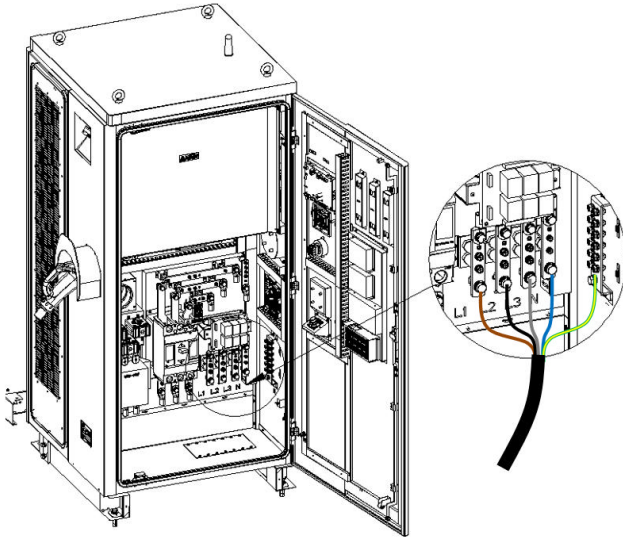

Connect the AC input cable by silk-printing L1, L2, L3, N, and PE at the copper bar

Note: Wiring and grounding must be performed by a professional electrician with an electrician's license.

3.4 Debug detection

After the charging device is properly installed, follow the procedure below to complete the debugging test (the debugging needs to be contacted with the

manufacturer or operated by a professional):

1. Check if the incoming terminal, circuit breaker and contactor terminal screws are tightened;
2. Power on the charging device;
3. Turn the circuit breaker switch in the device to ON;
4. Use a multimeter to measure whether the incoming power supply matches the input voltage in 1.2 specifications and technical parameters.
5. Check whether the device indicator is powered on.
6. Insert the plug, follow the 4.1 charging procedure, charge, check the indicator light and the screen status is normal;
7. At the end of normal charging, pull out the plug and complete the debugging test.

Instructions

4.1 Charging steps

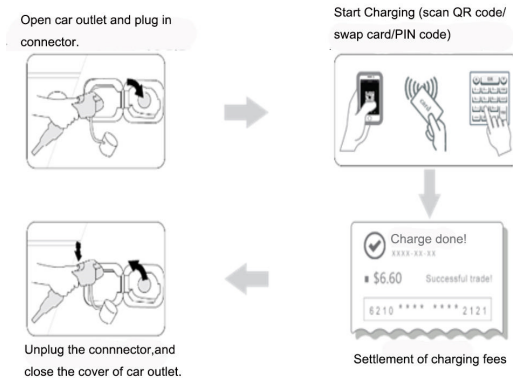

4.2 Precautions for use

- Please confirm the voltage parameters of the EV before connection (the input voltage exceeds the rated voltage, which may cause the device to smoke or fire).
- Before connecting the charger to the EV, please make sure there is no water or foreign matter in the charging plug and the charging socket on the electric car.
- When the charging plug is connected to the vehicle and the charging indicator lights up, it indicates that the charging plug is in the charging state. Please **DONOT** remove the charging plug at this time to prevent electric shock.
- Drivers and passengers should not stay in the car during charging.
- Pay attention to the strength when plugging and unplugging the charging cable. The force is too strong and prohibits violent insertion and removal.
- If the cable is damaged, please do not use it.
- During charging, if there is any odor, smoke, spark, or abnormal sound, vibration, electric leakage appear in the charger or vehicle, **PLEASE** press the emergency stop button to stop charging. It is strictly forbidden to directly disconnect the charging plug.
- Non-hazardous and special circumstances, do not press the emergency stop button at will.
- When the emergency situation is released, please turn the emergency stop button to restore, otherwise the charging cannot be continued.
- Please return the charging plug to the base in time after charging to avoid unnecessary damage to the charger.

For the safety of you and others, please use the series of charging devices correctly according to the usage described in this manual.

4.3 Setting dial code

Before put the power modular in, each of it should be set dial code. The dial code is a binary 8421 code format, and the high and low bits are arranged from right to left (as the fig below); The DIP switch is down, indicating 0, and it is up, indicating 1. Please see the example and the conversion information is in the following table. The maximum effective address of the dial code is 60.

Modular Number	Dial code
1	000001
2	000010
3	000011
4	000100
5	000101
6	000110



Example for dial code 3 (000011)

Note: after setting the dial code, the charger need to reboot

Troubleshooting

3.1 Position of device abnormal display

Indicator (red light); screen (alarm information)

3.2 Common troubleshooting methods

Problem	Possible reasons	Dealing methods
Cannot start when power is on	input voltage is too high or too low	Use a voltmeter to check that if the system input voltage/frequency meets the specifications.
No display/display abnormality after power-on	The power cord is loose	Reconnect the power cord.
	Input voltage is abnormal	Use a voltmeter to check if the system input voltage/frequency meets the specifications.
	Power supply circuit reversed	Check the TCU billing unit to see whether the positive and negative power supply circuits are reversed.
	Screen malfunction	Continuously tap the place at three-quarters of the top left corner of the screen to enter calibration mode and return to normal.
	Blue screen	The screen enters the calibration mode, and clicks the calibration cursor that appears in the upper left corner, upper right corner, lower right corner, lower left corner, and middle screen of the screen (if the calibration mode occurs frequently, please contact customer service center for processing).
Unable to charge	Charging plug is not connected	Check if the charging plug is connected.

Troubleshooting

	The vehicle is not turned off	Check if the vehicle has been turned off (some vehicles need to be turned on with the car key to charge).
	Network not connected	Check whether the network cable interface or 4G card is fixed, and confirm with the operator whether it is caused by network fluctuations.
	The voltage vehicle demands is higher than the module output voltage	Contact customer service center for processing.
	Fuse disconnect	Contact customer service center for processing.
Unable to open the machine after emergency shutdown	Emergency stop button is not reset after pressing	Rotate the emergency stop button to reset then power off and restart.
Unable to display the amount of charge properly	Energy meter communication interruption	Check if the energy meter interface is connected reliably.
Device offline	Poor contact of SIM card	Unplug the SIM card, relocate the SIM card and restart the device.
	SIM card failure	Restart the device after replacing the SIM card.
Charging trip	Front-end distribution box open specification	Replace the front-end power distribution box with open specifications.

Instructions for CL5830Charger

	selection error	
Repeatedly reconnect	Network instability	Enhance network signals or check the network cable interface.
Card locked	Improper operation	Contact the customer service center and bring the charging card to the customer service center to unlock.

If you encounter other abnormal conditions or cannot resume normal use after completing the above operations, please contact customer service center to solve.

After-sales service (Repair)

4.1 Inspection method

Daily check list for the charger (operation charger)

Name of Chargingstation			
Charger number			
1	Device outlook	Execution record	Dealing suggestions
1.1	Check if the display is normal (including whether the display unit is clear and identifiable).		If you find a problem, please calibrate the screen first; if it still does not work after calibration, please contact the relevant staff for display replacement.
1.2	Check whether the power indicator, fault indicator, and charge indicator are normal.		If you find a problem, please check if there is any problem with the wiring; if the wiring is correct, please replace the indicator.
1.3	Check that the paint layer of the charger is clean, the outer casing is deformed, the fixing is intact, and the charger is rusted.		If you find a problem, contact the relevant staff for charger repair; if it cannot be repaired, please return to the original factory for repair.
1.4	Check if the charging plug be able to plug-in and plug-out, if there is any foreign matter in the charging plug, and if the charging plug and cable are damaged.		If you find any problems, please contact the factory for repair.

Instructions for CL5830Charger

1.5	Check if the device door lock is normal.		If you find any problems, please contact the factory for repair.
1.6	Check whether charger and the base are well sealed, free from cracks and water leakage.		If you find a problem, please re-block or replace the base.
1.7	Check that the charger antenna is intact.		If damage is found, please contact the factory for replacement.
1.8	Check that the emergency stop button is intact and can be restored by a twist.		If you find that you can't screw it back, please contact the relevant staff to replace it.
1.9	Check that the device-related identification and operating instructions are clear and complete.		If the logo and instructions are found to be covered by stains, wipe with alcohol.
1.10	Check for water on the top of the charging unit.		If there is stagnant water, please dry it immediately after the rain stops.
1.11	Use a multi-meter to measure whether the charging device's output interface is live.		If you find a charge, please inform the relevant staff immediately.
	Check if the PG head (the position of the fixed plug and cable) is tightened		If the plug and cable are found to be loose, use a tool to fasten it back.

After-sales service (Repair)

2	Inside the device	Execution record	Dealing suggestions
2.1	Check that the screw connections between the wires and the electrical components are secure.		Make sure that all wires are securely connected to the screws of the electrical components.
2.2	Check that the wiring is intact and the cable insulation should be good and free from damage.		If the cable or control cable is damaged, replace it immediately.
2.3	Check that the cable connector is free of rust and the cable hole is well sealed.		If the joint is found to be rusty, please inform the relevant staff to replace it.
2.4	Check that the markings of all cables in the device are clear and correct.		If the cable identification is found to be disordered, please inform the relevant staff to make corrections.
2.5	Check if the digital display of the energy meter is clear.		If the measurement is found to be inaccurate, please inform the relevant staff to replace it.
2.6	Check if there is any water in the charger and the fireproof mud is sealed.		If you find a problem, please remove the accumulated water and reseal it with fireproof mud.
2.7	Check the cable for squeezing or twisting.		If you find a problem, remove the cable and reconnect it.
2.8	Check if the air filter is dirty.		Please use a high pressure air gun to clean the air filter regularly.
2.9	Check that the inside of the device is clean.		Please clean the dust inside the charger regularly.
Inspection			Inspection

department		personnel	
Date			

4.2 Repair/Replacement of Parts

During the warranty period, due to defective or normal deterioration, the charger damaged or cannot be used normally. Our company is responsible for the maintenance, debugging or replacement of spare parts for the user. If it is found to have deliberate acts such as disassembly, impact, smashing etc. the damage will be repaired, commissioned or replaced by our company with paid. After the warranty period, maintenance, debugging or replacement of parts should have been paid.

4.3 Upgrade Method

If you need to upgrade your charger, please inform our after-sales personnel. After-sales personnel will go to the site to upgrade the charging device or upgrade the software version via the platform remotely.

4.4 Repair and training

For charger repair and user training services, please contact our customer service center.